

Avéma

Pharma Solutions



Full CDMO. From Concept through Commercialization

Our products and capabilities include:

Solid & Liquid Dose OTC & Rx

- Tablets, Capsules
- Bottles, pump sprays

Full R&D Development capabilities

- Development Labs
- Stability

Product offerings include:

- Electrolytes
- Powders (Digestive)
- Nutrient
- Supplements
- Creams & Lotions
- Smoking Cessation



Packaging
15 BN solid oral
dosages



Manufacturing &
Packaging
60 MM units
of digestible liquid
units



Complete Turnkey CDMO

Solid Dose, Liquid, Rx and OTC in house development to complete commercialization... including in-house serialization.

Solid Dose packaging line

Swift Pack bottling line

- Serialization
 - Aggregation to the pallet level



Corporate Headquarters & Centers for Operational Excellence

Two NEW Facilities:

New NRT and NOW Gummies!
Manufacturing Facilities (Copiague, NY...Formally TEVA site)

New 135,000 Sq. Ft Site in Miami

New York
Cantiague Rock Road



New York
Westbury & Farmingdale



South Carolina
Clinton



FACILITIES



200 N. Oak Street



33 Ralph Avenue



26 Bethpage Road

South Carolina
OGR



California
Lynwood



Florida
Miami



LOCATION	FUNCTION	SQUARE FOOTAGE	REPRESENTATIVE PRODUCTS
Westbury, NY	HQ, Distribution	50,000	Finished product packaging
Copiague, NY	Manufacturing & Packaging	93,000	Nicotine Gum
Copiague, NY	Nutritional Gummy Manufacturing	100,000	Nutritional gummies
Long Island, NY	Packaging and Distribution	350,000	Solid dose OTC Drugs
Clinton, SC	Manufacturing, Packaging & Distribution	250,000	First aid products
Piedmont, SC	Manufacturing, Packaging & Distribution	200,000	OTC drugs, first aid products, electrolytes
Duncan, SC	Distribution	220,000	First aid products
Lynwood, CA	Manufacturing, Packaging & Distribution	325,000	Liquid OTC drugs and electrolytes
Miami, FL	Solid Dose Manufacturing, Corporate R&D	230,000	OTC and Rx Drugs

PLD operates a network of 12 facilities across the US including state-of-the-art manufacturing, packaging and distribution centers. All sites are FDA-certified and adhere to cGMP guidelines.

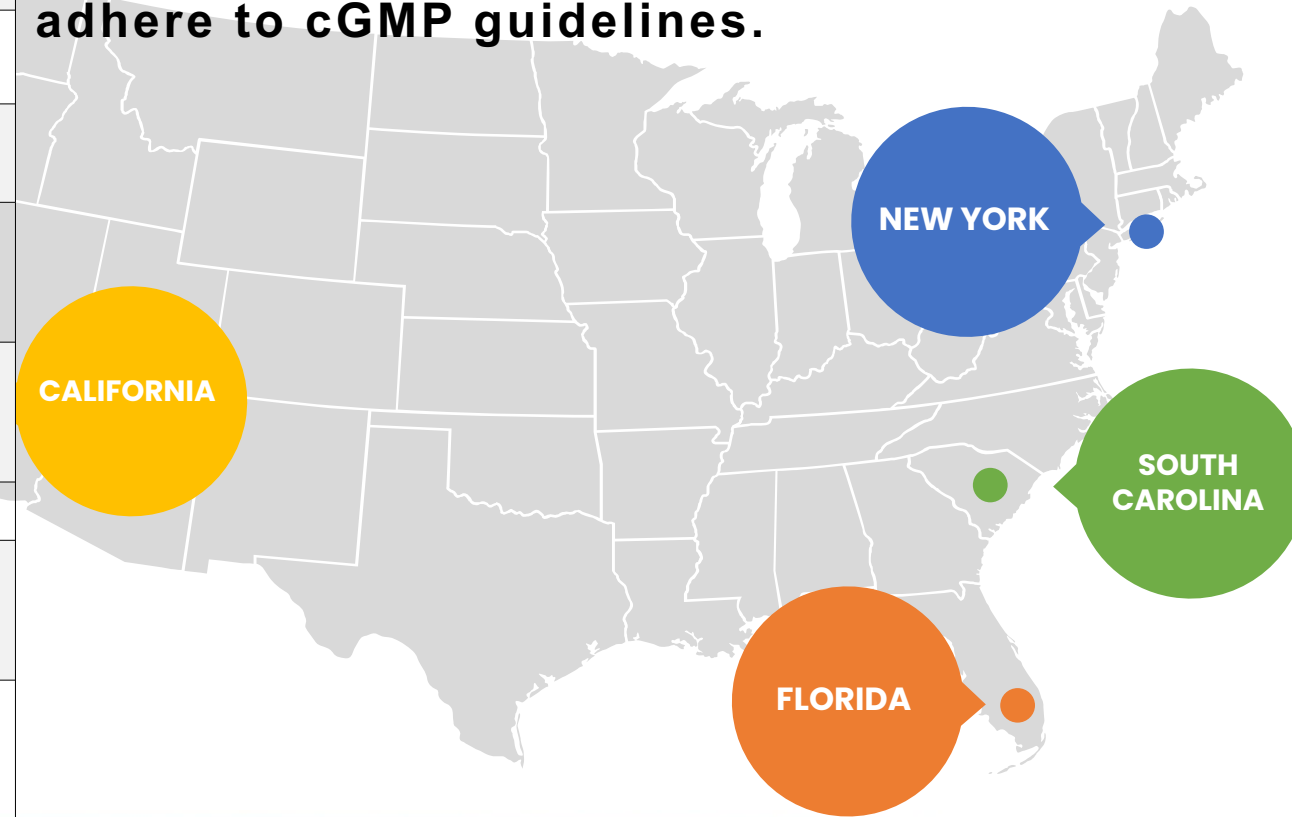

Avéma/PLD Miami: Manufacturing & R&D

From product development to commercialization. We have the talent and tools necessary to assist you in taking your product to market



- 225,000+ Sq. ft of cGMP manufacturing, QC, R&D site and offices to support:
 - Manufacturing Operations
 - R&D Laboratory
 - QC Laboratory
 - Engineering Services & EHS
 - Project Management
 - Production Planning & Logistics
 - Regulatory Compliance/QA
 - Validation/Technical Services
 - Human Resources
 - Information Technology
- **5.5-6.0 billion units annually** in solid oral dosage form manufacturing capacity with Excellent quality and compliance record

We continue to expand our capacity and services

NEW Facility in Miami:

135,000 Sq. Ft Site in Miami

- New expanded R&D Pilot Lab
- New expanded R&D Analytical Labs

Huge opportunity for growth

- New Liquid filling lines
- New Packaging lines with Serialization

A very large space to accommodate our manufacturing growth !



Avéma Miami Floor Plan

- A. WIP Warehouse
- B. Dispensing
- C. Blending
- D. Fette 3200 Rooms
- E. Synthesis 700 room
- F. Healthstar JMCO
- G. Synthesis 500 rooms
- H. Bosch 1500 suite
- I. 24/36 in Coating Pan Suite
- J. 48 in Coating Pan Suite
- K. 60 in Coating Pan Suite
- L. Equipment Cleaning Area
- M. Fluid Bed Granulation Suite
- N. Pilot liquid compounding line & commercial filling line
- O. Bottle packaging line & pilot blister line
- P. Future suite of 2 rooms with 1000 gallon tank for liquid compounding

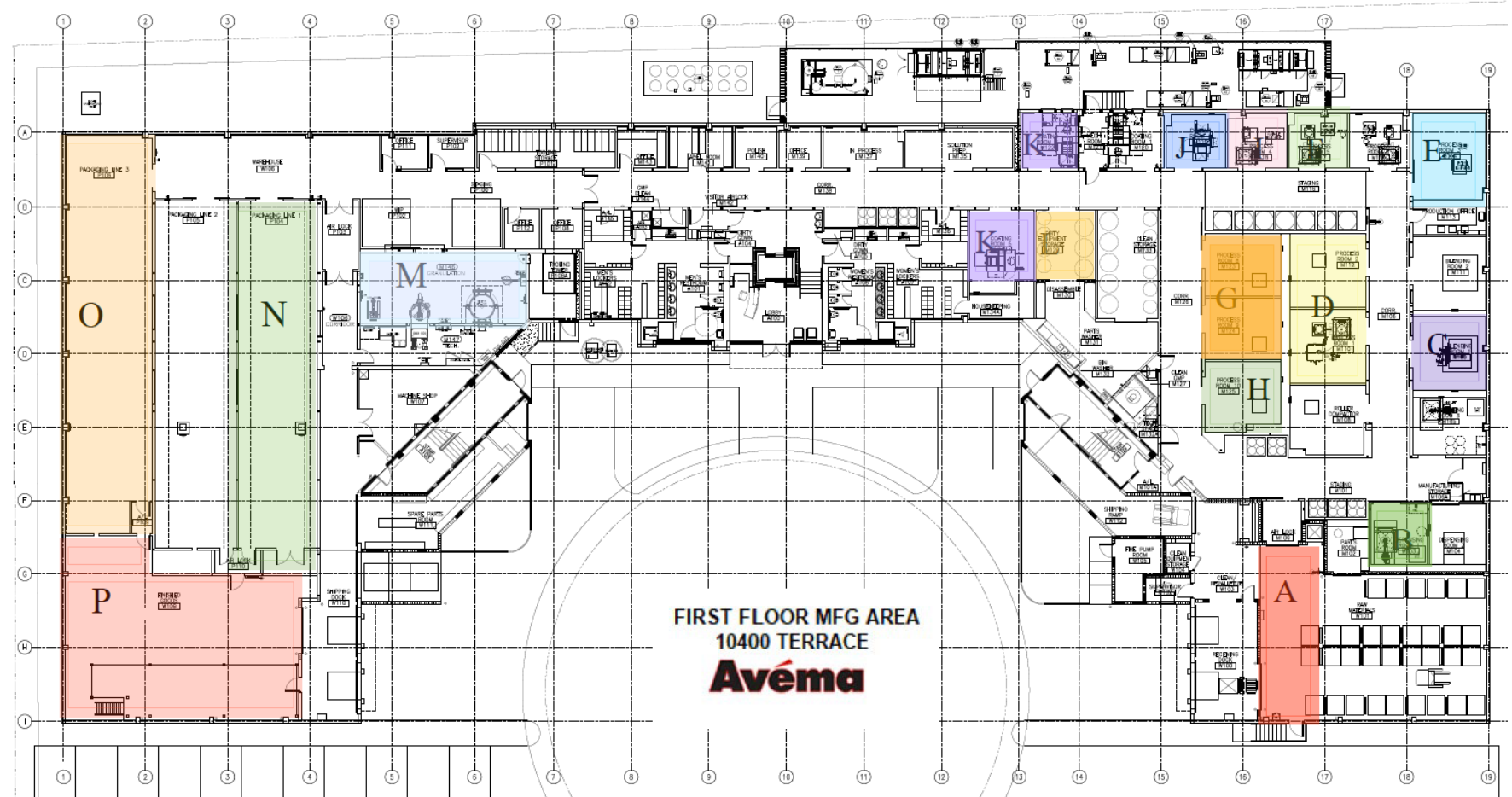

Confidential

Avéma Miami: R&D Development

- State-of-the-art laboratory with capabilities to do raw material testing, finish good testing and method development
- Pre-formulation, formulation development, process development, and validation of complete solid and liquid dose systems, including tablets and capsules, as well as suspensions and solutions
- Process design, testing and validation for all new products
- Analysis of raw materials and quality assessments at every step of our manufacturing and packaging processes
- Five stability chambers to monitor product quality thru lifecycle including a walk-in chamber
- Advanced analytical instrumentation for physical and chemical property analysis
- Development and validation of analytical methods



Avéma Miami: Expanded R&D Center Moving into New Building

Formulation Development

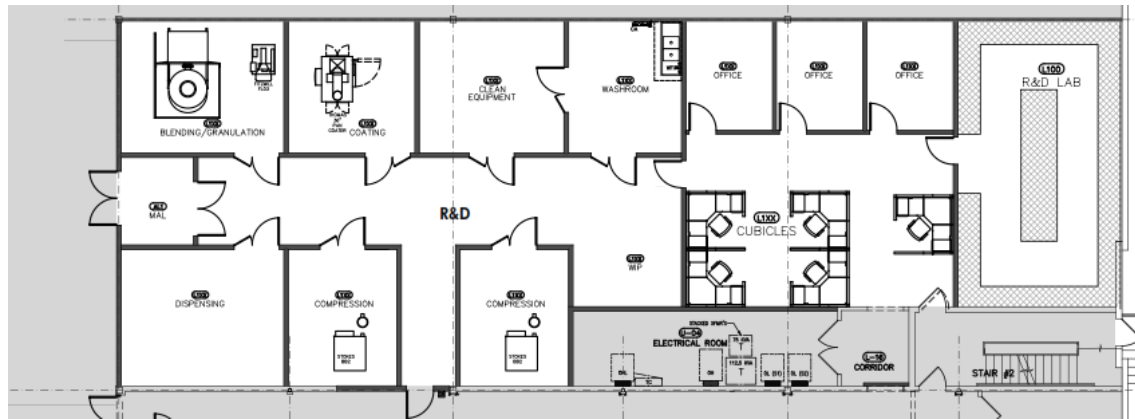

Analytical Development

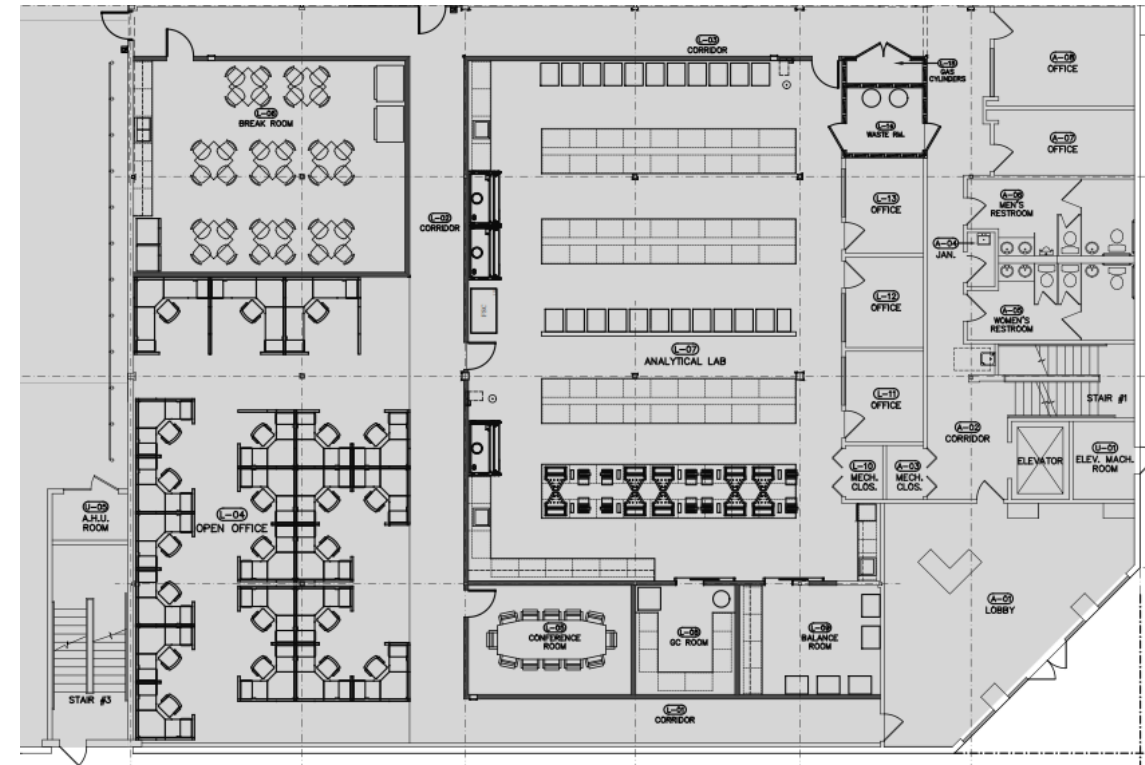

Confidential

Why Avéma/PLD Contract Services?



35+ years of Rx formulation development experience

Experience with Rx, OTC, & dietary supplements manufacturing

Extensive library of formulas

Diverse mix of manufacturing equipment .

Full CDMO capabilities

- *R&D and product /Formulation Development*
- *Analytical laboratories*
- *Method development and validation*
- *Incoming raw material testing*
- *Finish product testing*
- *Experienced in pre-clinical and clinical studies.*